

# Conversion Hospital Rohrbach

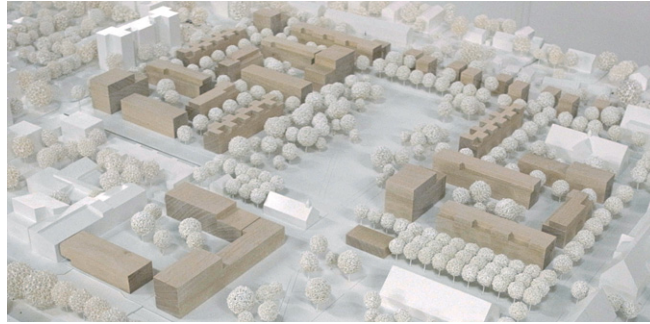

01

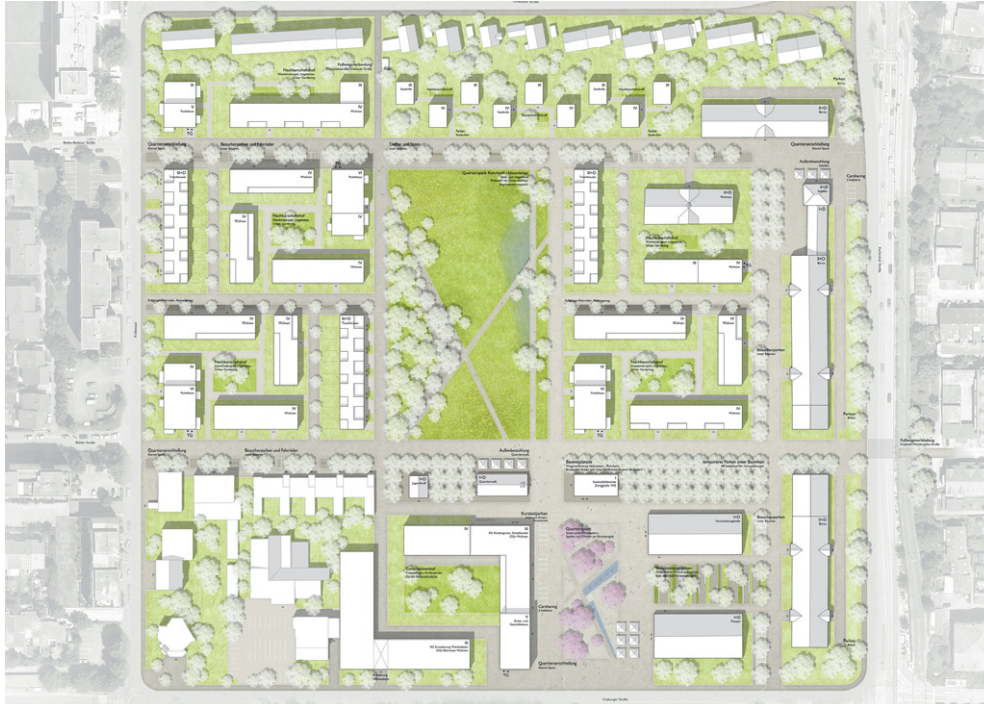

03



02

## Conversion Hospital Rohrbach / 2014

Project	KRH
Client	City of Heidelberg
Status	Open urban planning ideas competition 3rd Prize
Site	9,5 ha
GBA	68.250 m <sup>2</sup>
Landscape	Silands, Ulm

The conversion area in the south of Heidelberg is transformed into a town piece that embeds the former white spot into the surrounding urban fabric. This opening happens to be in a balance of maintaining existing structures and of introducing new qualities of a sustainable urban quarter.

The main concept consists of three open spaces that link the site with its surroundings and structure it into manageable building plots: a central park, a band reaching from east to west and a square for the quarter. Smaller public

programs are put in place on the tree esplanade: a youth club in the ancient gatehouse, a café for the quarter in the former church and a small library. The two listed halls are utilized as a theatre and as a big space for events for the whole quarter. The historic barracks along the Karlsruher Straße lend themselves to commercial use like offices. Typologies in varying kind and density fill the building plots. Four-storey slabs form courtyards. Townhouses and detached urban villas with three and four storeys complement the manifold offer of housing for different groups of inhabitants.



04



05



06

07

- ←
- 01 Model | Ensemble
  - 02 View towards peoples café, wooden park to the right
  - 03 Master Plan
  - 04 Distribution of program
    - living
    - public/ culture
    - working and services
  - 05 Urban structure and open space plan
  - 06 Ground floor plan
  - 07 1<sup>st</sup> floor plan

