

# Bruhweg II Gerlingen



01

## District Bruhweg II Gerlingen / 2017

Project	BWG
Client	City of Gerlingen
Status	Restricted urban planning ideas competition <u>Acknowledgement prize</u>
Site	12,6 ha
Landscape	Lavaland + Treibhaus, Berlin

The concept aims to develop a sustainable quarter with well-arranged neighbourhoods. Besides the interlinking with the surrounding special attention is paid to the identity creating quality of the green strip and the conflict-free arrangement of living and commercial areas. Though mixed-use areas and the green strip form buffer zones.

Within the green strip that gives place to recreational activities rain water is drained off towards the commonly used compensation area. In its centre an expansion forms a spatial focal point with small retail, gastronomy and bus stops.

The western edge of the quarter is spatially defined by four-storey slabs. Five and six-storey buildings mark special points such as the entrances to the quarter and the centre. Mixed typologies are placed on the plots: row houses and semi-detached houses complement the manifold offer for housing besides the apartment buildings.



←

- 01 Master plan
- 02 Concept diagrams:  
Figure-ground  
Access and traffic  
Open space concept
- 02 Model:  
Central green strip  
Production / commercial zone
- 04 Green strip detail in plan and section

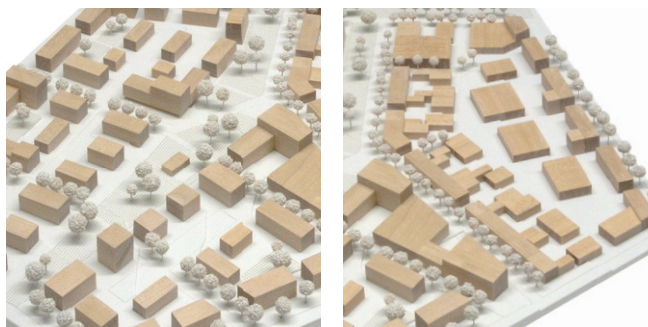

03



02

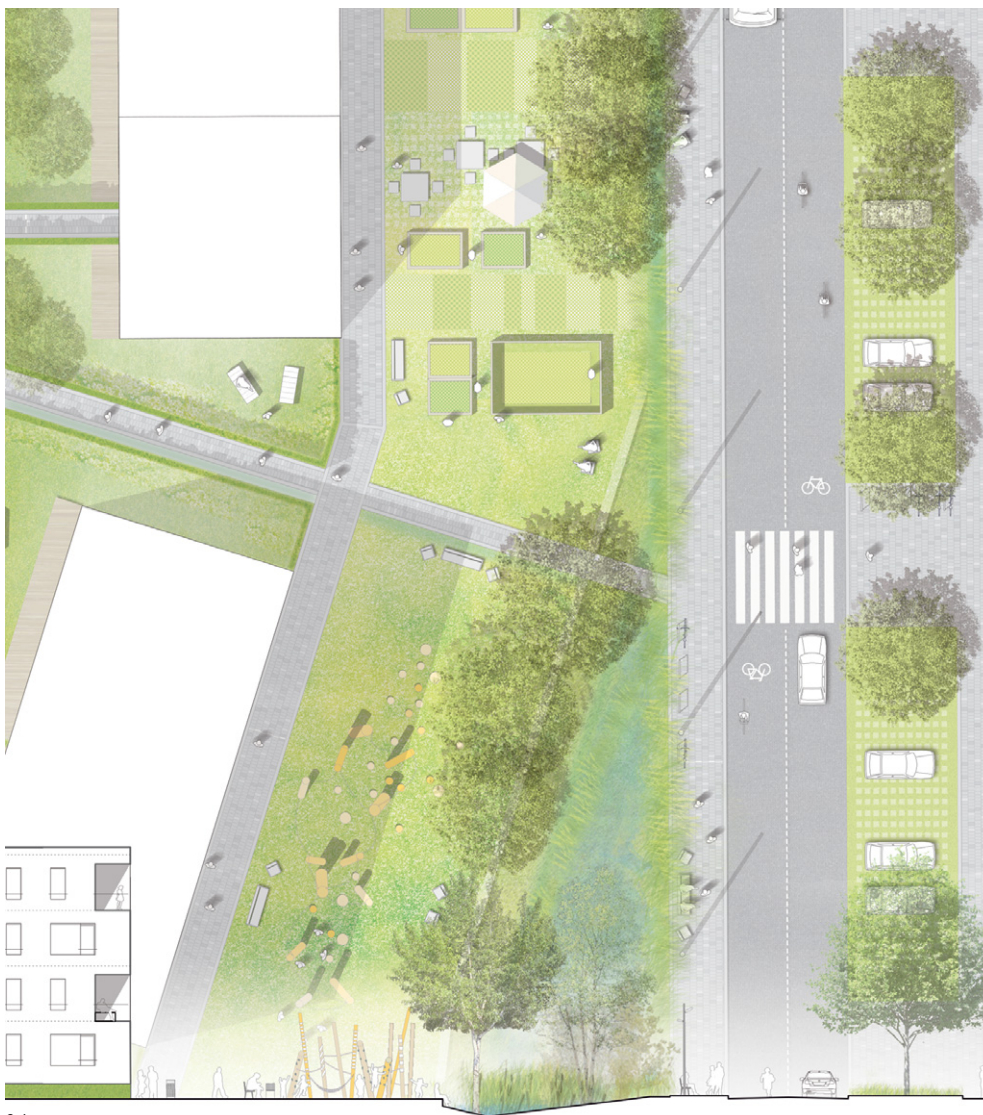

04

In addition to the bigger industrial surfaces commercial blocks are provided for smaller businesses such as craft and services. A differentiated circulation system interlinks the area with the surrounding. Spatial enlargements form smaller entrées to the area at the access points. In the sense of a sustainable mobility electric charging stations are offered in the parking garages.